

<One Body pin>

Pitch : 0.80mm

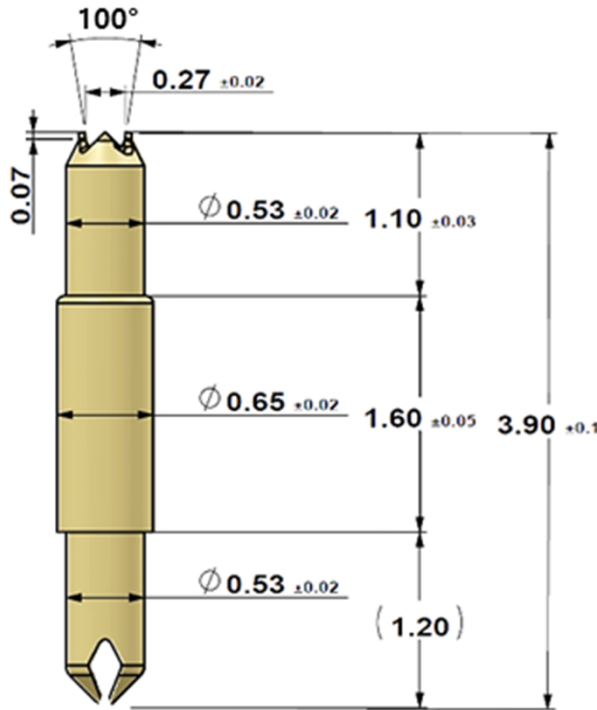
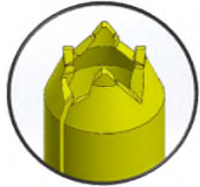

▪ **Mechanical Specification**

- Recommend Stroke : 0.60mm
- Full Stroke : 0.80mm
- Operating Temperature (Unbiased) : -40°C ~ 150°C
- Life Span : >300,000 (Mechanical)

▪ **Electrical Specification**

- Current Rating : 5A continuous
- Resistance : Max 100mΩ

▪ **Materials and Plating**

- Barrel : BeCu (C1720 1/2H) / Au plating
- Spring : BeCu (C1720 1/2H)
- Plunger : BeCu (C1720 1/2H) / Au plating

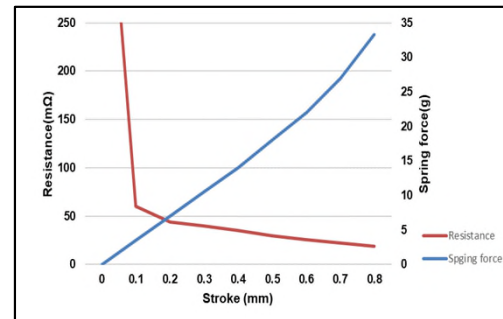

6538BC-20

Recommend Stroke : 0.60mm (20gf±20%)
Full Stroke : 0.80mm (34gf±20%)

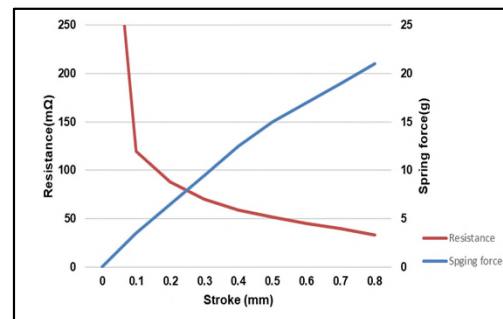

6538BC-17

Recommend Stroke : 0.60mm (17gf±20%)
Full Stroke : 0.80mm (21gf±20%)